

# BE POWER<sup>®</sup> EQUIPMENT

## DIESEL GENERATOR USER MANUAL

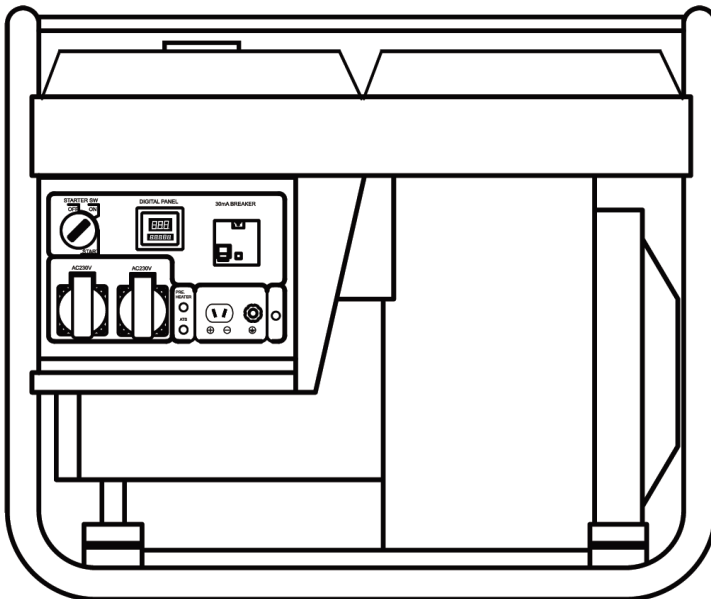

123 G7900D-ILET | 123 G7900D-ILET3  
123 G10000D-ILET | 123 G10000D-ILET3















## CONTENTS

<b>SAFETY</b> .....	<b>3</b>
<b>CONTROL PANEL ELEMENTS</b> .....	<b>4</b>
<b>FILTER POSITION</b> .....	<b>6</b>
<b>BEFORE START</b>	
- <b>OIL FILLING</b> .....	<b>7</b>
- <b>CONNECTING THE BATTERY CABLE</b> .....	<b>8</b>
- <b>FILLING THE FUEL TANK</b> .....	<b>9</b>
- <b>REMOVE AIR FROM FUEL PIPE</b> .....	<b>10</b>
<b>OPERATION</b>	
- <b>START</b> .....	<b>11</b>
- <b>AUTO START</b> .....	<b>12</b>
- <b>STOP</b> .....	<b>13</b>
<b>MAINTENANCE</b>	
- <b>OIL CHANGE</b> .....	<b>14</b>
- <b>OIL FILTER CLEAN</b> .....	<b>15</b>
- <b>AIR FLITER</b> .....	<b>16</b>
- <b>FUEL FILTER</b> .....	<b>17</b>
<b>TECHNICAL DATA</b> .....	<b>18</b>
<b>TROUBLESHOOTING</b> .....	<b>19</b>

**DISCLAIMER:** The information, specifications, procedures, and diagrams provided for this machine are subject to change at any time without prior notice. Updates may occur due to product improvements, regulatory requirements, or technical revisions. Always refer to the most current documentation and verify details with the manufacturer or authorized service provider before use.

# DIESEL GENERATOR USER MANUAL

## SAFETY

	Perform a visual inspection of the external and internal components.		Always store the generator in an area with good ventilation.
	The generator is designed for operation within a temperature range of +5°C to +40°C.		For long-term storage, keep the equipment in a dry location. Frost can cause damage. Ensure the equipment is thoroughly dried before storing it in a dry, room temp area.
	REGULARLY clean the air filter. All filters must be cleaned regularly. All components must be cleaned regularly		Never place the generator in an inclined or vertical position, to avoid fuel loss and equipment damage
	The exhaust gases contain carbon monoxide This gas is colorless and highly dangerous. NEVER OPERATE THIS EQUIPMENT INDOORS OR IN POORLY VENTILATED AREAS.		The exhaust becomes very hot during operation and remains warm for some time after the generator is switched off. Avoid touching the exhaust and allow the equipment to cool down completely before moving it.
	Repairs on the generator must be carried out by a qualified or authorized professional.		Do not smoke or allow open flames or sparks near the generator, especially when refueling. To prevent fire or explosion hazards, do not store the generator near flammable materials.
	Always inspect the equipment for any screws or nuts that may have loosened due to vibration.		Failure to follow the procedures outlined in this manual may result in equipment damage and will void the warranty.
	ALWAYS use high-quality oil and fuel. Regularly check oil and fuel levels, and ensure that oil and fuel filters are properly maintained.		

## CONTROL PANEL ELEMENTS

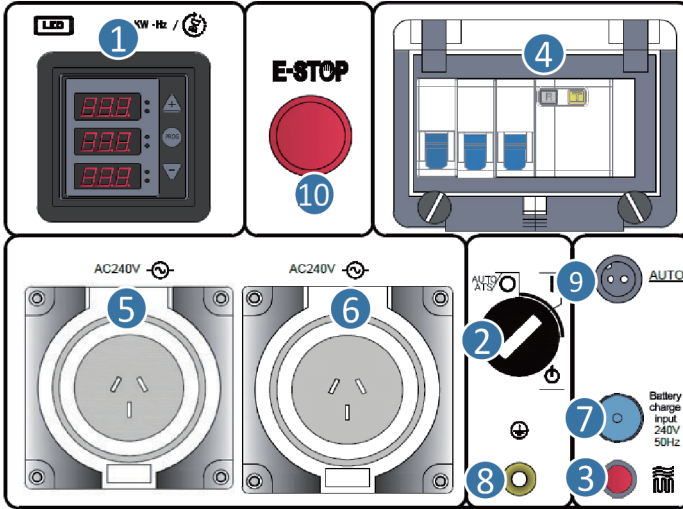

No	Parts Name
1	LED6 Display
2	Start key
3	Air-preheater button
4	SAA breaker
5	240V-15A Single phase socket
6	240V-15A Single phase socket
7	Battery charger socket
8	Ground terminal
9	AUTO socket
10	E-STOP

**CONTROL PANEL ELEMENTS**

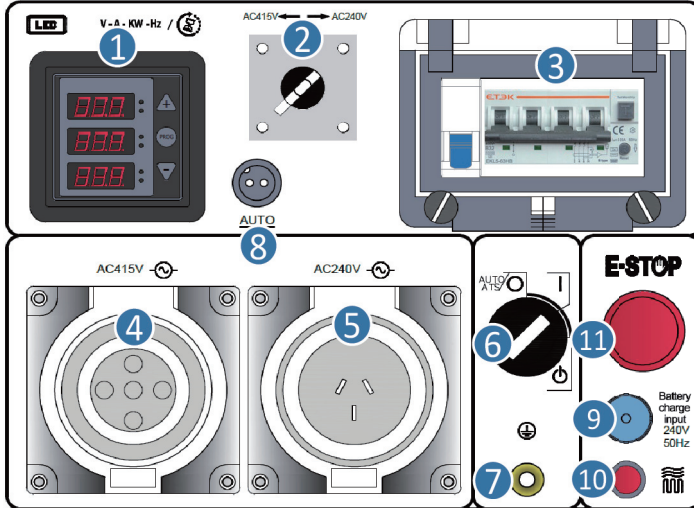

<b>No</b>	<b>Parts Name</b>
<b>1</b>	LED6 Display
<b>2</b>	Turnover switch 415V-240V
<b>3</b>	SAA breaker
<b>4</b>	415V-32A Three phase socket
<b>5</b>	240V-15A Single phase socket
<b>6</b>	Start key
<b>7</b>	Ground terminal
<b>8</b>	AUTO socket
<b>9</b>	Battery charger socket
<b>10</b>	Air-preheater button
<b>11</b>	E-STOP

## FILTER POSITION

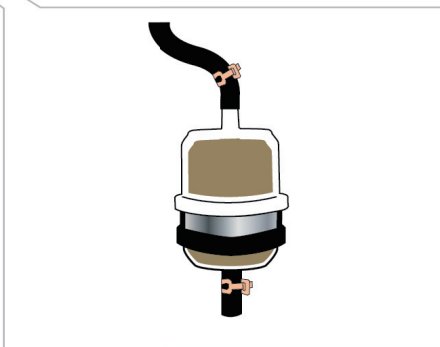
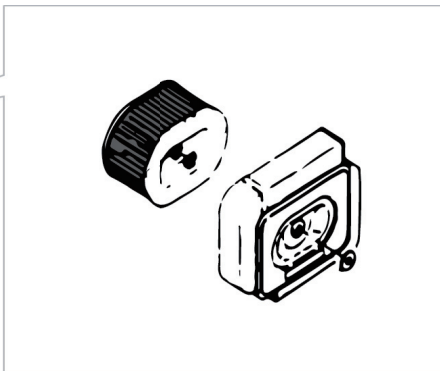

## OIL FILLING



1

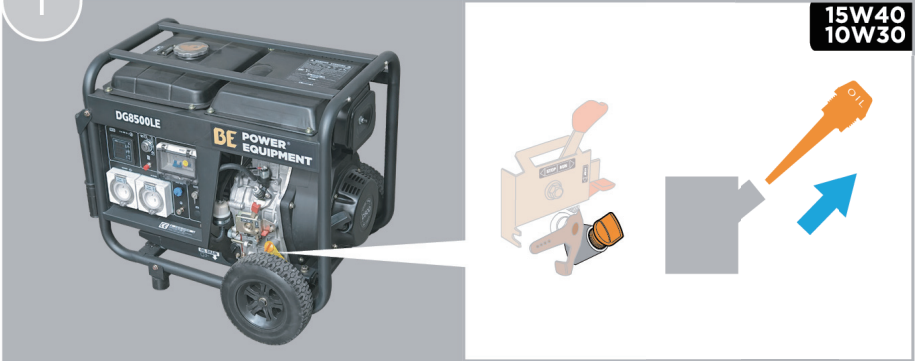

2

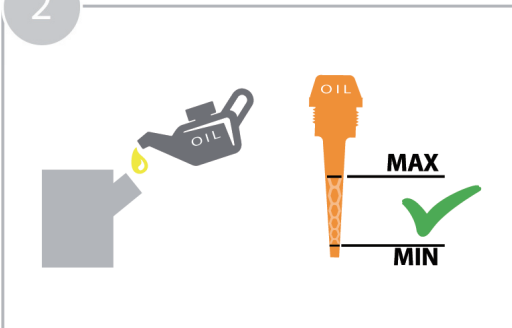

3

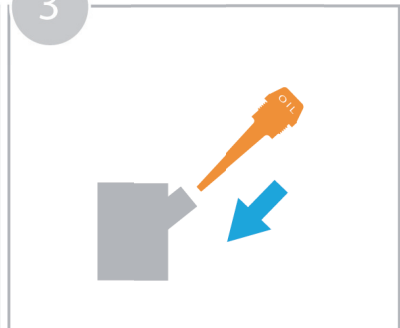

## CONNECTING THE BATTERY CABLE

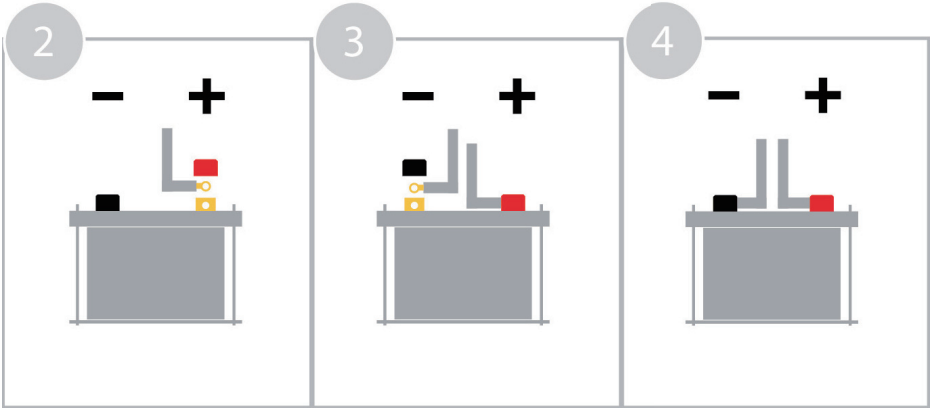
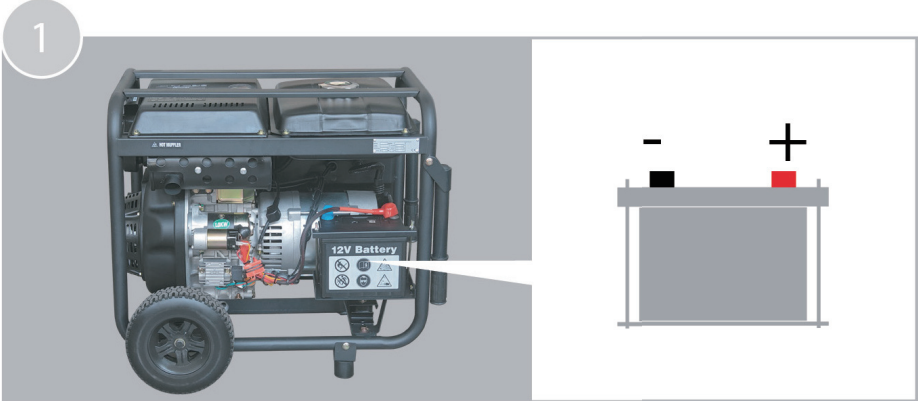

## FILLING THE FUEL TANK

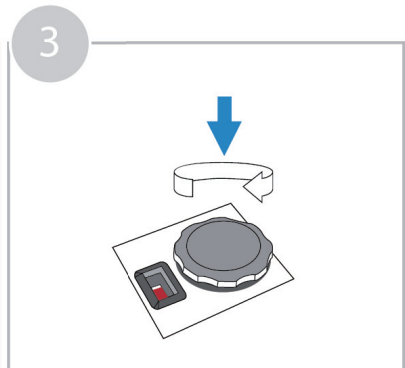
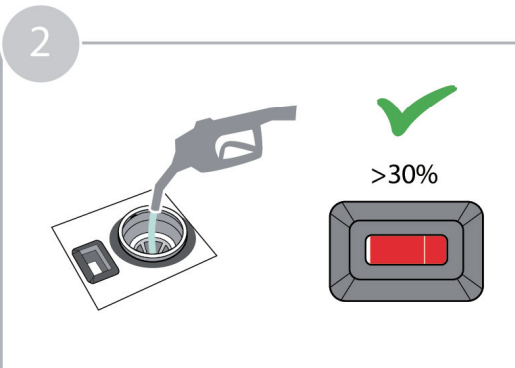
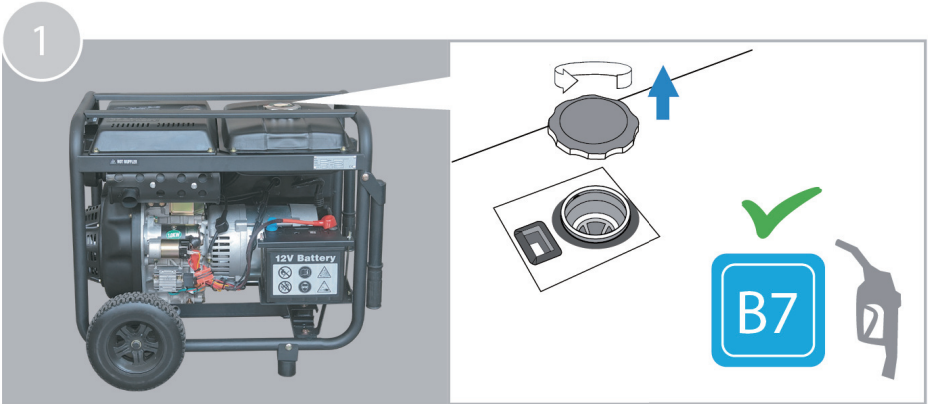

## REMOVE AIR FROM FUEL PIPE



1

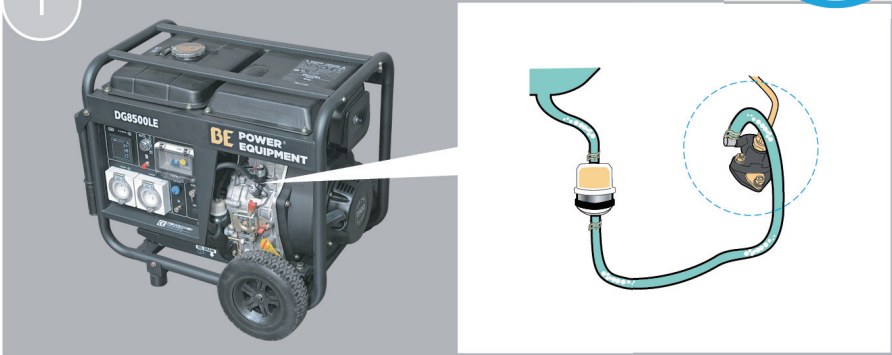

2

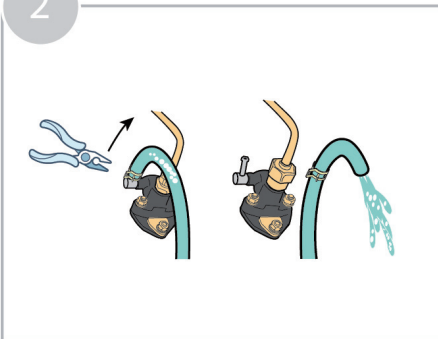

3

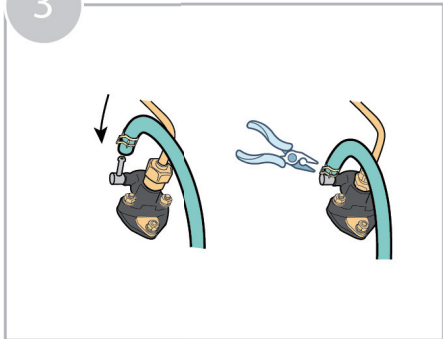

## OPERATION - START



Check the oil level whenever the appliance is to be put into operation.  
Add engine oil if necessary.



To ensure quality, each piece of equipment undergoes a test run and is filled with motor oil.  
Although the oil is drained before transport, some residue may remain on the dipstick.  
Please check the oil level carefully and top up with motor oil as needed.

1

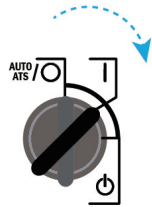
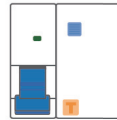

2

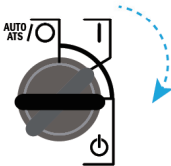

<5s



>5s



3

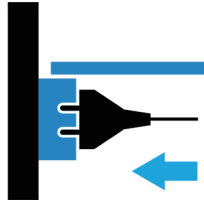

4

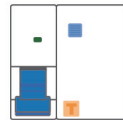

## OPERATION - AUTO START



Check the oil level whenever the appliance is to be put into operation.  
Add engine oil if necessary.



To ensure quality, each piece of equipment undergoes a test run and is filled with motor oil.  
Although the oil is drained before transport, some residue may remain on the dipstick.  
Please check the oil level carefully and top up with motor oil as needed.

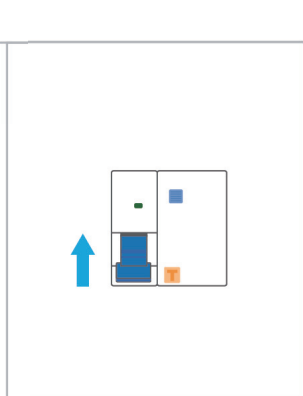
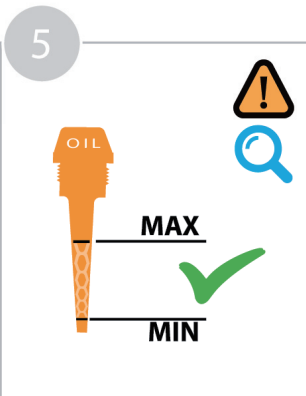
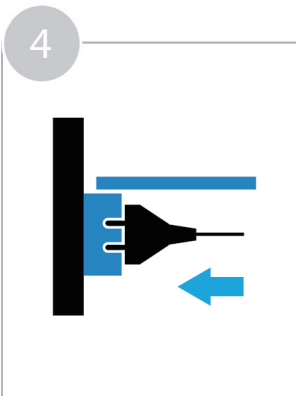
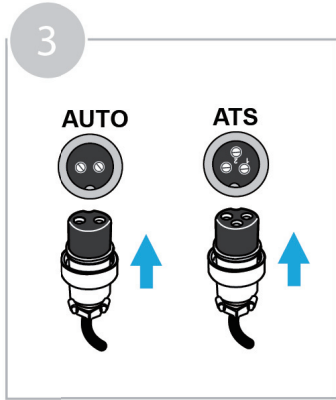
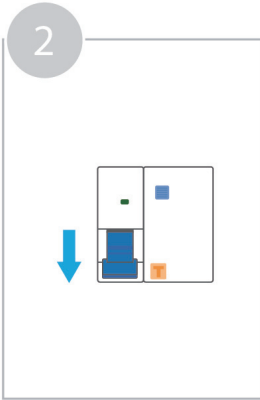
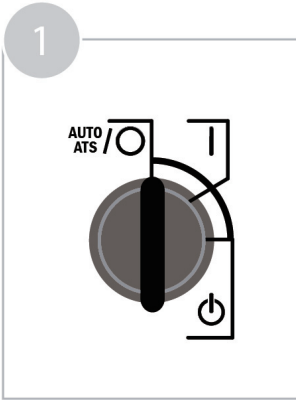

## OPERATION STOP

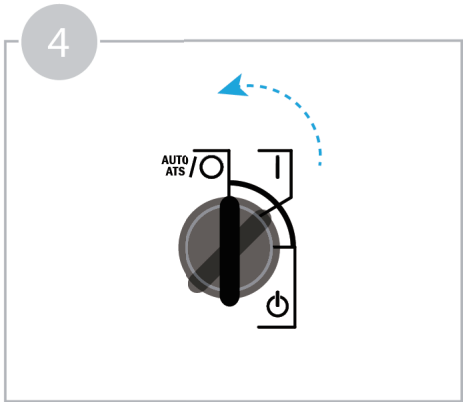
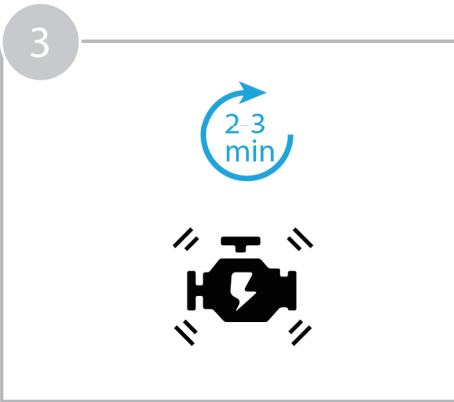
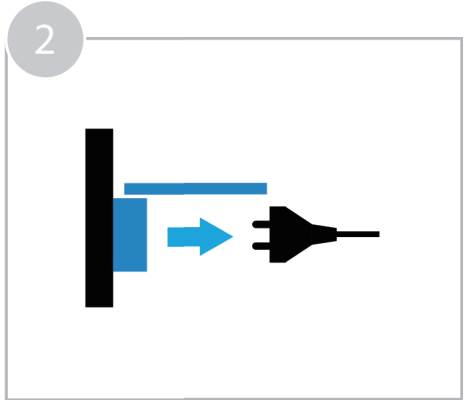
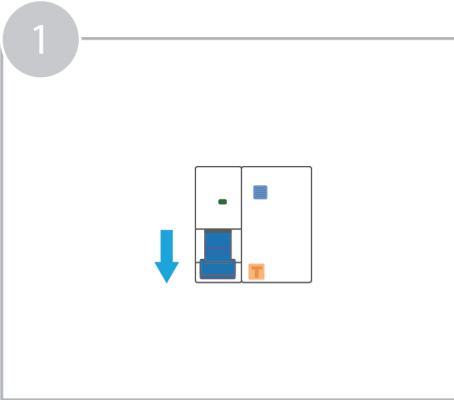

## OIL CHANGE



15W40  
10W30

1



2



3

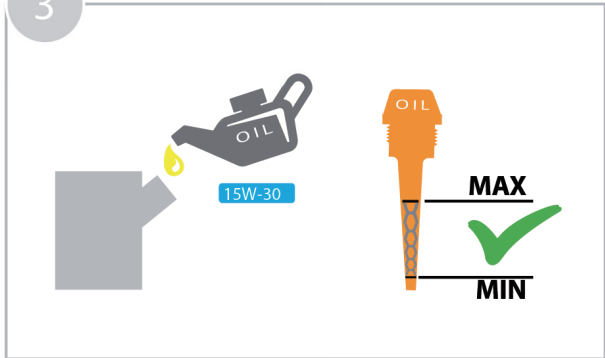

## OIL FILTER



1

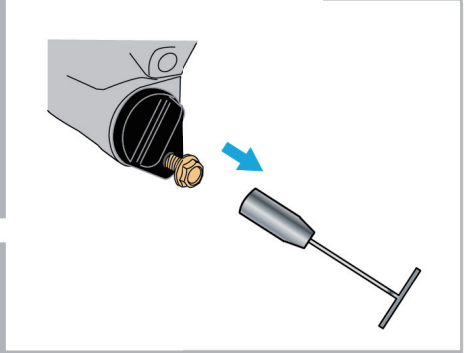

2

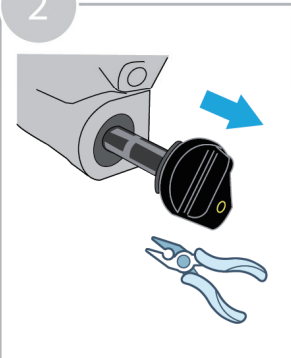

3



4

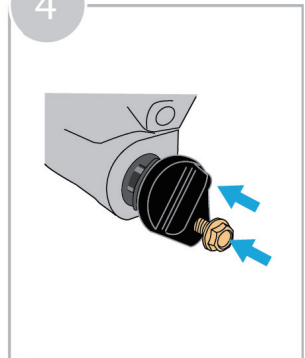

## AIR FILTER

every  
100  
hours

1



2

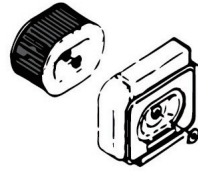

3

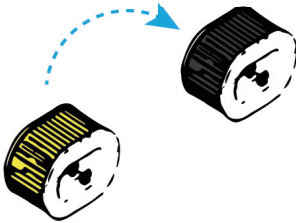

4



## FUEL FILTER

every  
100  
hours

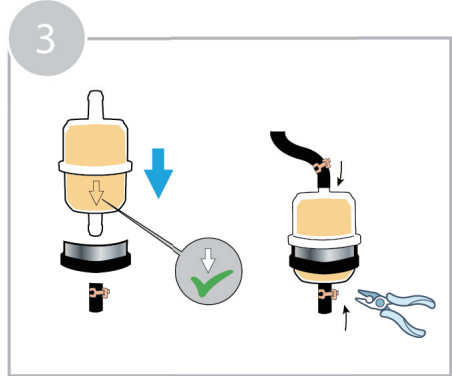
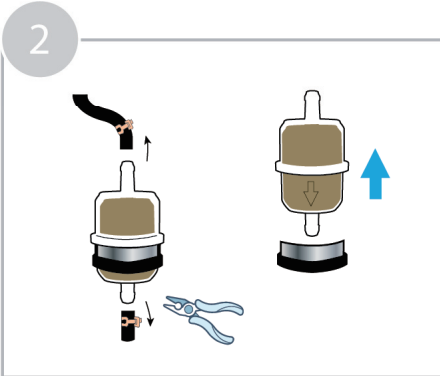
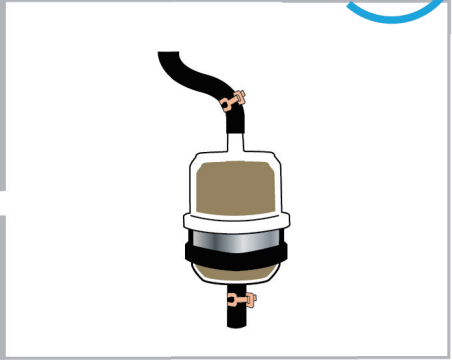

## TECHNICAL DATA

MODEL		G7900D-ILET	G7900D-ILET3	G10000D-ILET	G10000D-ILET3
Frequency	Hz	50	50	50	50
Rated Power	kw	5.5	5.0 / 6.9 kva	8	7.2 / 10 kva
Max. Power	kw	6.3 kw	5.8 / 7.9 kva	8.5	7.6 / 10.6 kva
Voltage	V	240	240 / 415	240	240 / 415
Current	A	26.3	26.2/11A	35.4	31.7 / 14.7
Plugs	A	15A	15A / 32A	15A	15A / 32A
Display		LED6	LED6	LED6	LED6
Fuel Tank Capacity	L	10	10	10	10
Running Time @ 75% Load	H	5.5	5.5	4	4
Sound Level @ 7m	dBA	79	79	79	79
DC Output	V/A	-	-	-	-
Battery	V/Ah	12 / 30	12 / 30	12 / 36	12 / 36
ENGINE		D500E	D500E	D680E	D680E
Engine Type		Diesel	Diesel	Diesel	Diesel
Power	HP	12	12	14.4	14.4
Start		Manual / Electric	Manual / Electric	Electric	Electric
Displacement	CC	498	498	678	678
Oil Capacity	L	1.75	1.75	2.4	2.4
ALTERNATOR		AL6	AL6-T	AL8	AL8-T
Power	kw	6	6	8	8
Power Factor		1	1 / 0.8	1	1 / 0.8
Voltage Regulation		Brush / AVR	Brush / AVR	Brush / AVR	Brush / AVR
DIMENSIONS & WEIGHT					
Net Weight	kg	116	116	140	140
Gross Weight	kg	120	120	148	148
Machine Size	mm	760x480x600	760x480x600	760x550x670	760x550x670
Package Dimensions	mm	780x500x630	780x500x630	780x570x700	780x570x700

## TROUBLESHOOTING

### MOTOR NOT STARTING



#### CAUSES



#### SOLUTIONS



Fuel shortage

Fill with fuel



Air in the circuit

Drain air from circuit



The start lever is not in the on position

Put the lever in the on position



Not enough oil

Fill with oil to the upper mark on the rod



Injector dirt

Clean the injector



Dead Battery

Charge or replace battery



The injector does not supply fuel

Replace the injector

### GENERATOR DOES NOT GIVE CURRENT



#### CAUSES



#### SOLUTIONS



The lever is in the off position

Put the lever in the on position



Bad contact at plug

Adjust plug

**AVR**

Damaged voltage regulator (AVR)

Replace voltage regulator (AVR)

**BE** POWER<sup>®</sup>  
EQUIPMENT