

4

3

2

1

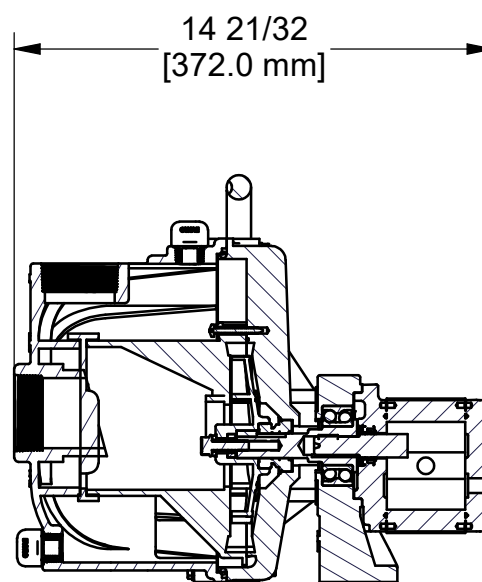
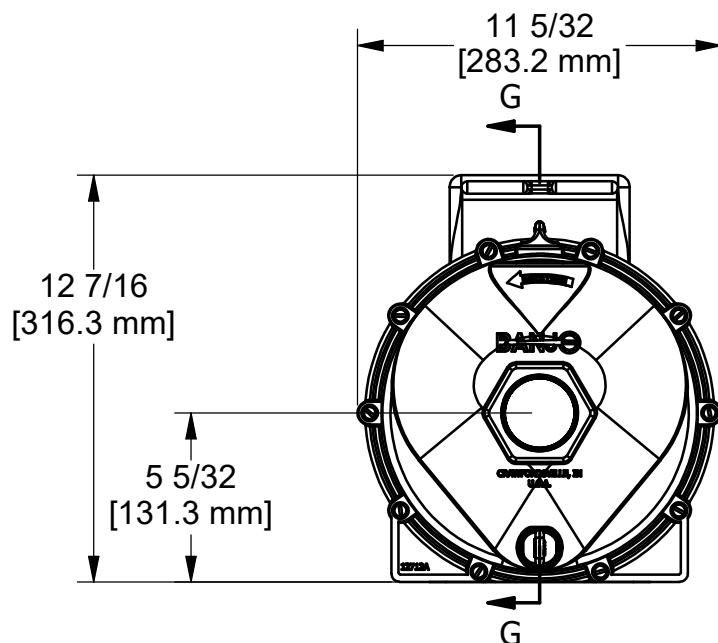

SECTION A-A
SCALE: 1/4

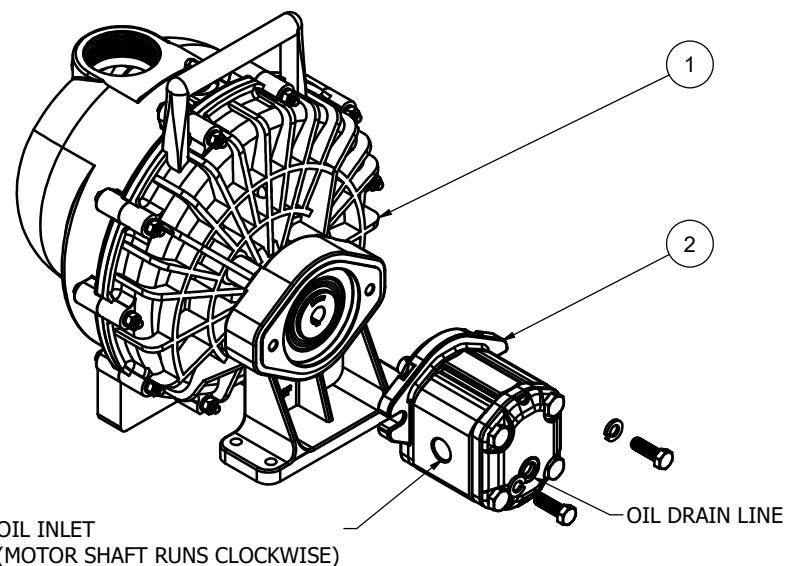

Parts List

ITEM	QTY	PART NUMBER	DESCRIPTION
1	1	200PHA	2" POLY PUMP W/O HYD. MOTOR
2	1	HY10131B	MARZOCCHI HYD. MOTOR 9.6 CC

MARZOCCHI HYDRAULIC MOTOR:
ALM2A-R-13-AC9/16-FG-V-E1-HS-P870
DISPLACEMENT 9.6 C.C
MAX R.P.M. 4000
MAX CONT. PRESSURE 250 BAR
IN/OUT THREADED CONNECTIONS 1/2" G

OIL DRAIN LINE MUST BE CONNECTED TO TANK:
MAX PRESSURE ADMISSIBLE 5 BAR
OIL DRAIN LINE THREADED CONNECTION 1/4" G

PUMP REPAIR KIT:
12000A
12000AV FOR FKM SEALS
10861 FOR WET SEAL ONLY KIT

PEDESTAL MOUNTING HOLES:
4 HOLES Ø8.70 mm
INTERAXES: 38.10 mm / 143.70 mm



BANJO CORPORATION
150 BANJO DRIVE, CRAWFORDSVILLE, IN 47933
WEB SITE: WWW.BANJOCORP.COM
E-MAIL: BANJOSALES@IDEXCORP.COM

DESCRIPTION

2" POLY PUMP WITH MARZOCCHI HYD.
MOTOR

PART NUMBER

200PHY-E

THIS DRAWING AND ALL
INFORMATION CONTAINED THEREON
ARE THE EXCLUSIVE PROPERTY OF
BANJO CORPORATION.

UNLESS SPECIFICALLY NOTED, THIS
DRAWING AND ITEMS SHOWN ON
THIS DRAWING ARE SUBJECT TO
CHANGE AT ANY TIME.

4

3

2

1